



altro

the future is safer with altro

CI/SfB reference
43 T U47

July 2011

Altro Whiterock™ hygienic PVCu wall cladding to junction with P250 PVCu direct fix ceiling detail

typical specification (Ref: CF7)

JULY 2011

Fix 12.5mm thick plasterboard (or similar) to timber joists (joists not to exceed 600mm centres). Fix Altro P259 PVCu perimeter trim direct to underside of plasterboard using 25mm wafer head screws. Fix Altro P250 PVCu ceiling boards direct to underside of plasterboard with 25mm

wafer head screws, ensuring alignment with timber joists above. Slot the Altro P250 PVCu ceiling boards into P259 PVCu trim. Altro Whiterock PVCu wall cladding fixed behind P259 PVCu trim and joint sealed with silicone sealant (A802/A805).

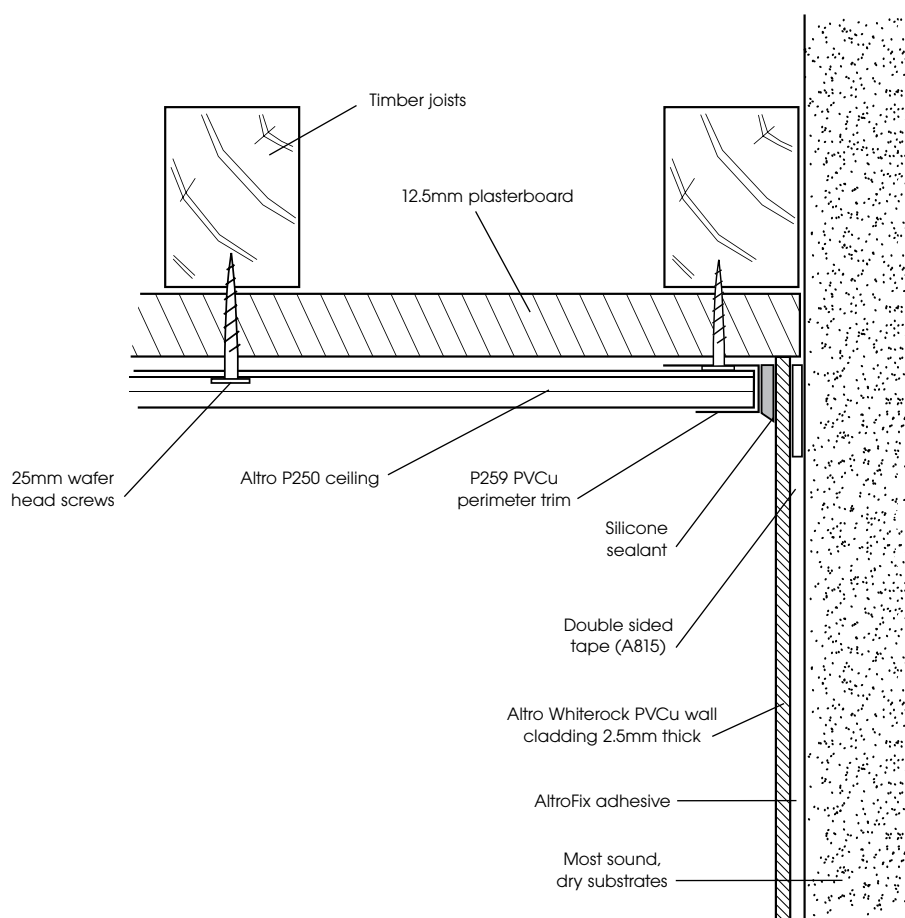

for further information or technical advice

tel: 01462 707600 fax: 01462 707504

e-mail enquiries@altro.com or explore www.altro.com