



altro

the future is safer with altro

# Altro Whiterock™ hygienic PVCu wall cladding to junction with P250 PVCu direct fix ceiling detail (incorporating PMF6 ceiling section as counterbattens)

typical specification (Ref: CF6)

JULY 2011

Fix PMF6 perimeter channel to perimeter of room. Mechanically fix PMF6 Perimeter channels to underside of concrete soffit at maximum 600mm centres. Fix P259 PVCu perimeter trim to underside of PMF6 channel with 13mm wafer head screws. Fix Altro P250 PVCu ceiling boards to

underside of PMF6 channel battens with 13mm wafer head screws, slotting in to P259 PVCu perimeter trim. Altro Whiterock PVCu wall cladding fixed behind P259 PVCu trim and joint sealed with silicone sealant (A802/A805).

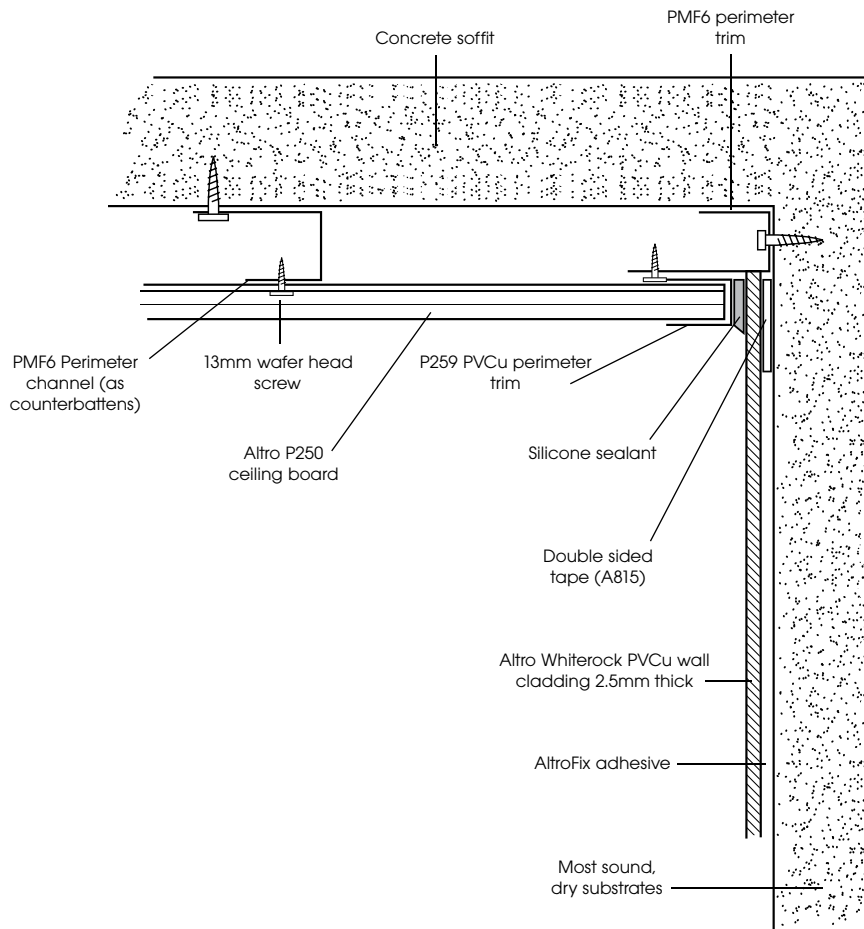

for further information or technical advice

tel: 01462 707600 fax: 01462 707504

e-mail [enquiries@altro.com](mailto:enquiries@altro.com) or explore [www.altro.com](http://www.altro.com)