



altro

the future is safer with altro

CI/SfB reference
43 T U47

July 2011

Altro Whiterock Quickclad™ PVC wall cladding to Altro resin flooring detail

typical specification (Ref: QWF3)
system 1 – direct fix detail

JULY 2011

Altro Whiterock Quickclad rigid PVC foam sheets fixed to a galvanised steel stud framework system, consisting of head and sill channels (Ref: AMF6) and vertical studs (Ref: PMF5) fixed with wafer head screws (Ref: 611). Vertical studs fixed at maximum 600mm centres. The void between substrate and back of panel can be adjusted using packers/shims behind the vertical metal supports. This will accommodate a void from minimum 30mm up to maximum of 49mm.

Packers/shims should be positioned at nominal 1000mm centres. Fix transition strip (A872) to front face of vertical metal supports with self tapping hard point screws at the appropriate skirting height. To provide a suitable substrate for the resin flooring skirting, fix 9mm WBP resin bonded plywood to the vertical metal studs with 25mm x No 6 Posidrive self tapping hard point screws. Fix PVC joint strip cover after installation of the resin floor skirting.

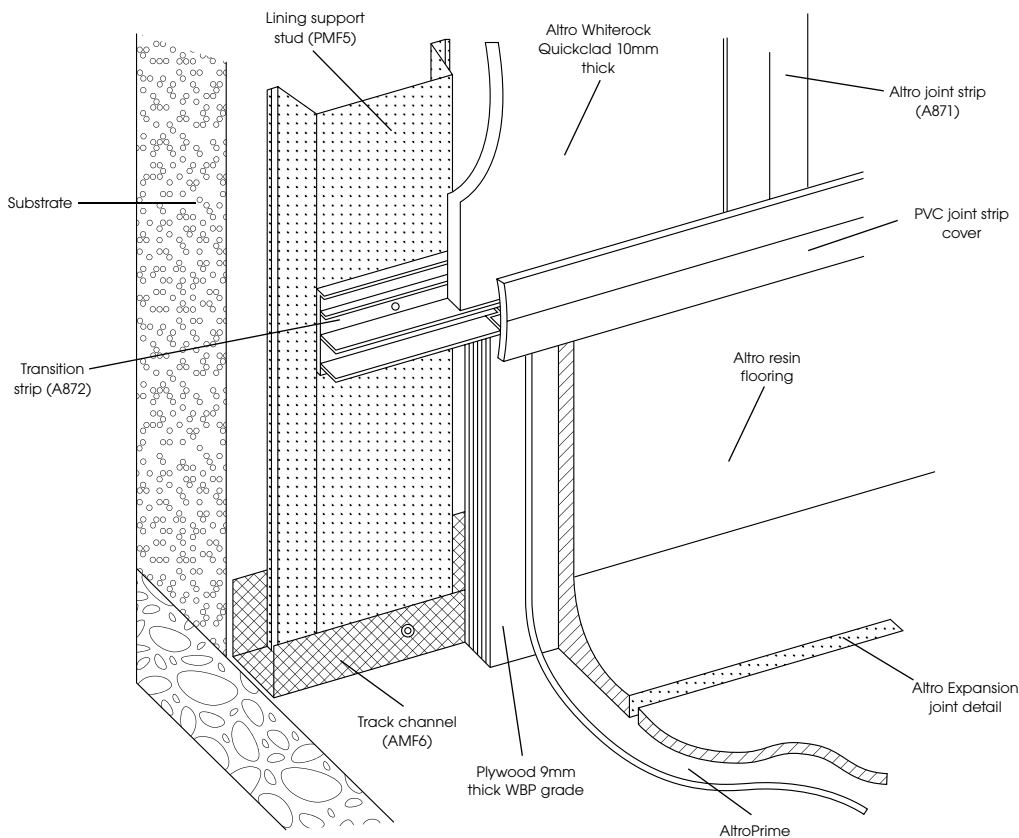

for further information or technical advice

tel: 01462 707600 fax: 01462 707504

e-mail enquiries@altro.com or explore www.altro.com