



altro

the future is safer with altro

CI/SfB reference
(43) T (U47)

July 2011

Altro Whiterock Quickclad™ PVC wall cladding to quarry tile floor detail

typical specification (Ref: QWF5)

system 1 – direct fix detail

JULY 2011

Altro Whiterock Quickclad rigid PVC foam sheets fixed to a galvanised steel stud framework system, consisting of head and sill channels (Ref: AMF6) and vertical studs (Ref: PMF5) fixed with wafer head screws (Ref: 611). Vertical studs fixed at maximum 600mm centres. The void between substrate and back of panel can be adjusted using packers/shims behind the vertical metal supports. This will accommodate a void from minimum 30mm up to

maximum of 49mm. Packers/shims should be positioned at nominal 1000mm centres.

To provide a suitable substrate for the quarry tile skirting, fix 9mm WBP resin bonded plywood to the vertical metal studs with 25mm x No 6 Posidrive self tapping hard point screws. Apply Altro silicone sealant (Ref: A802) at the junction of PVC cladding and skirting.

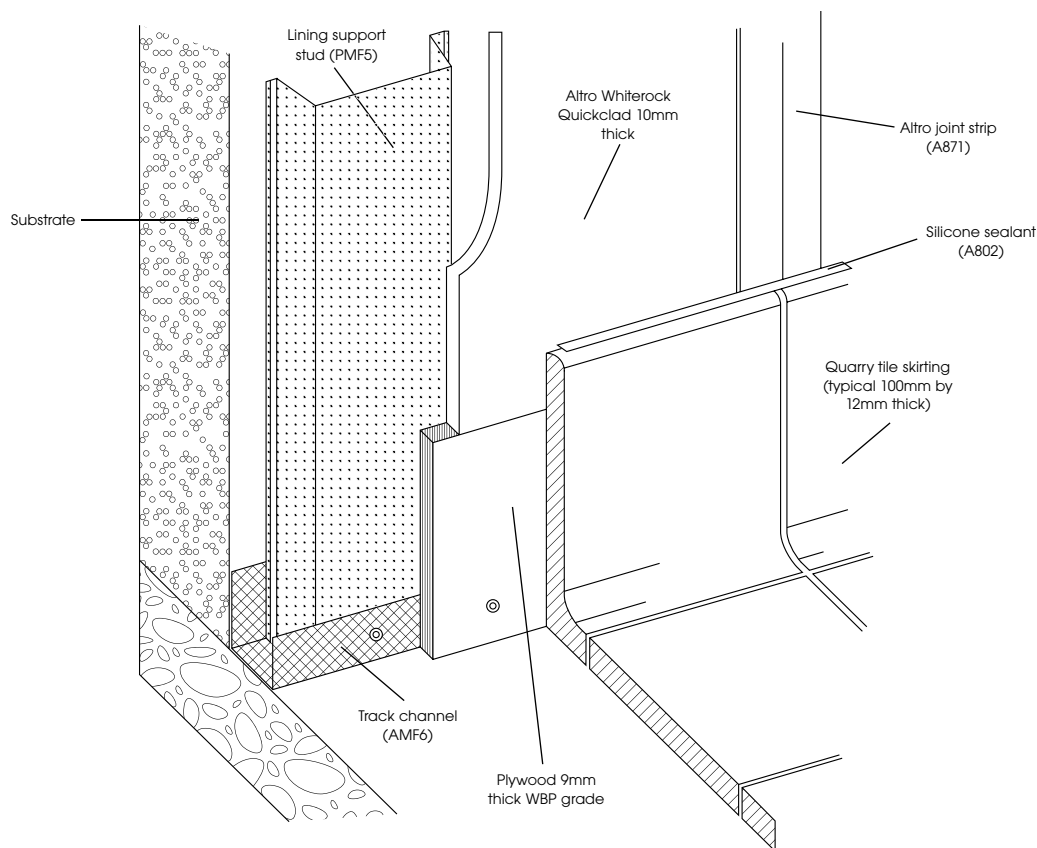

for further information or technical advice

tel: 01462 707600 fax: 01462 707504

e-mail enquiries@altro.com or explore www.altro.com